

ITEM NO:CTB01

- END CONNECTOR: THREAD, SOCKET, FLANGE
- WORKING PRESSURE:150PSI

Specification of material

TRUE UNION BALL VALVE

NO.	PART	MATERIAL	Q'TY
1	Stem	CPVC	1
2	Handle	ABS	1
3	Stem O-Ring	EPDM	2
4	Union Nut	CPVC	2
5	End Connector	CPVC	2
6	Body O-Ring	EPDM	2

NO.	PART	MATERIAL	Q'TY
7	O-Ring	EPDM	2
8	Body	CPVC	1
9	Ball	CPVC	1
10	Seat Seal	PTFE	2
11	Seat Carrier	CPVC	1
12	Carrier O-Ring	EPDM	1

TRUE UNION BALL VALVE

Dimensions

Nom Size	NPT Thd./in	BSPT Thd./in	JIS d1	BS d1	ANSI d1	DIN d1	d2	D1	D	I	L1	L2	H
15mm(1/2")	14	14	22	22	21.34	20	14	27.6	51.2	20.6	112.5	65	50.5
20mm(3/4")	14	14	26	26	26.67	25	18.7	35.6	65.5	24.6	130.2	75	58.5
25mm(1")	11.5	11	32	34	33.4	32	24	41.6	73.7	28	142.5	85	65.7
32mm(1 1/4")	11.5	11	38	42	42.16	40	32	52	86.6	31	161	97	76.5
40mm(1 1/2")	11.5	11	48	48	48.26	50	40	59.5	102	31.5	166.5	110	86
50mm(2")	11.5	11	60	60	60.33	63	50	75	120	40	214	133.5	101.5
65mm(2 1/2")	8	11	76	76	73.03	75	60	87.5	135	40	228	161	112.5
80mm(3")	8	11	89	89	88.9	90	79	107.5	188	48	269	200	160.5
100mm(4")	8	11	114	114	114.3	110	99	132	216	56	309	240	173.5

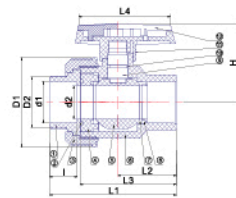

ITEM:CSU01

- END CONNECTOR: THREAD, SOCKET, FLANGE
- WORKING PRESSURE:150 PSI

Specification of material

SINGLE UNION BALL VALVE

NO.	PART	MATERIAL	Q'TY
1	End Connector	CPVC	1
2	Carrier O-Ring	EPDM	1
3	Union Nut	CPVC	1
4	Seal Carrier	CPVC	1
5	Ball	CPVC	1
6	Body	CPVC	1

NO.	PART	MATERIAL	Q'TY
7	Seat Seal	PTFE	2
8	O-Ring	EPDM	2
9	Stem	CPVC	1
10	Stem O-Ring	EPDM	2
11	Handle	ABS	1

SINGLE UNION BALL VALVE

Dimensions

Nom Size	NPT Thd./in	BSPT Thd./in	JIS d1	BS d1	ANSI d1	DIN d1	d2	D2	D1	I	L1	L2	L3	L4	H
15mm(1/2")	14	14	22	22	21.34	20	14	27.6	51.3	20.6	95.8	25.3	67.3	65	49.5
20mm(3/4")	14	14	26	26	26.67	25	18.7	35.2	65.5	25	111.4	32.4	78.3	74.9	56.5
25mm(1")	11.5	11	32	34	33.4	32	24	41.6	73.7	27.9	121.5	49.5	85.9	85	65
32mm(1 1/4")	11.5	11	38	42	42.16	40	32	49	86.6	27.0	130	57	99	97.1	76.5
40mm(1 1/2")	11.5	11	48	48	48.26	50	40	60.8	102	34.5	157.5	69.0	113.5	109.7	86.5
50mm(2")	11.5	11	60	60	60.33	63	50	74.5	120	40	190	81	136.5	190.0	102
65mm(2 1/2")	8	11	76	76	73.03	75	60	89	135	40	210	95.9	156	161	113.5
80mm(3")	8	11	89	89	88.9	90	79	107.5	188	48	254.6	120.9	196.5	199.4	161.5
100mm(4")	8	11	114	114	114.3	110	99	132	215.5	56	294	140.7	225	240	174

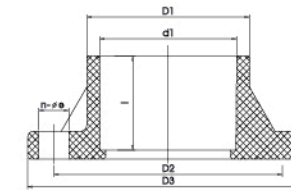

ITEM NO: CTF01

- 235PSI MAXIMUM INTERNAL PRESSURE RATING @73° F
- MATERIAL : CPVC

TS FLANGE

Dimensions

Nom Size	D1	D2	D3	d1 DIN	d1 ANSI	d1 JIS	d1 BS	I	n-ø e
1/2"	30	60.5	89	20	21.34	22	22	22	4-16
3/4"	34	70.5	98	25	26.67	26	26	23.5	4-16
1"	42.5	79.5	108	32	33.4	32	34	25.5	4-16
1 1/4"	52	89.5	118	40	42.16	38	42	32	4-16
1 1/2"	61.5	98.5	127	50	48.26	48	48	32.5	4-19
2"	76	120.5	151.5	63	60.33	60	60	35.8	4-19
2 1/2"	89.5	139.5	177.3	75	70.03	76	76	41	4-19
3"	107.5	152.5	191	90	88.9	89	89	48.5	4-19
4"	130.5	190.5	228.5	110	114.3	114	114	58.5	8-19

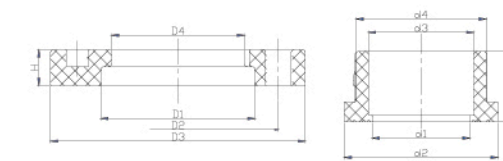

ITEM:CVF01

- MATERIAL : CPVC

VAN STONE FLANGE

Dimensions

Nom Size	d1	d2	d3	d4	h	D1	D2	D3	D4	H
2"	51	91.8	58	74.6	43.5	92.5	120	152.4	77.6	20.5
2 1/2"	68	107.2	73.4	90.6	49	107.6	140	177.6	92.6	24.8
3"	77.2	119.9	89.4	107	54.9	120.6	152.5	191.4	109.4	26.4
4"	102.4	152.5	110.4	131.8	64.8	153	191	229.7	134	28.5

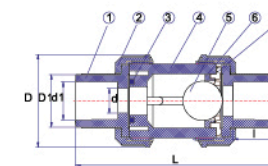

ITEM:CBC02

BALL CHECK VALVE

Specification of material

NO.	PART	MATERIAL	Q'TY
1	End Connector	CPVC	2
2	Union Nut	CPVC	2
3	Stem O-Ring	EPDM	1
4	Body	CPVC	1

NO.	PART	MATERIAL	Q'TY
5	Ball	CPVC	1
6	Gland	CPVC	1
7	Seat	EPDM	1

BALL CHECK VALVE

Dimensions

Nom Size	NPT Thd./in	BSPT Thd./in	JIS d1	BS d1	ANSI d1	DIN d1	d	D1	D	I	L
15mm(1/2")	14	14	22	22	21.34	20	15	27.5	51.3	20.5	105
20mm(3/4")	14	14	26	26	26.67	25	19.5	35.0	65.5	25	116.5
25mm(1")	11.5	11	32	34	33.4	32	25	41.6	73.7	28	130.5
32mm(1 1/4")	11.5	11	38	42	42.16	40	32	51.6	86.8	29.5	148.5
40mm(1 1/2")	11.5	11	48	48	48.26	50	40	60.9	102	34	168.5
50mm(2")	11.5	11	60	60	60.33	63	50	75	119.8	40	189